

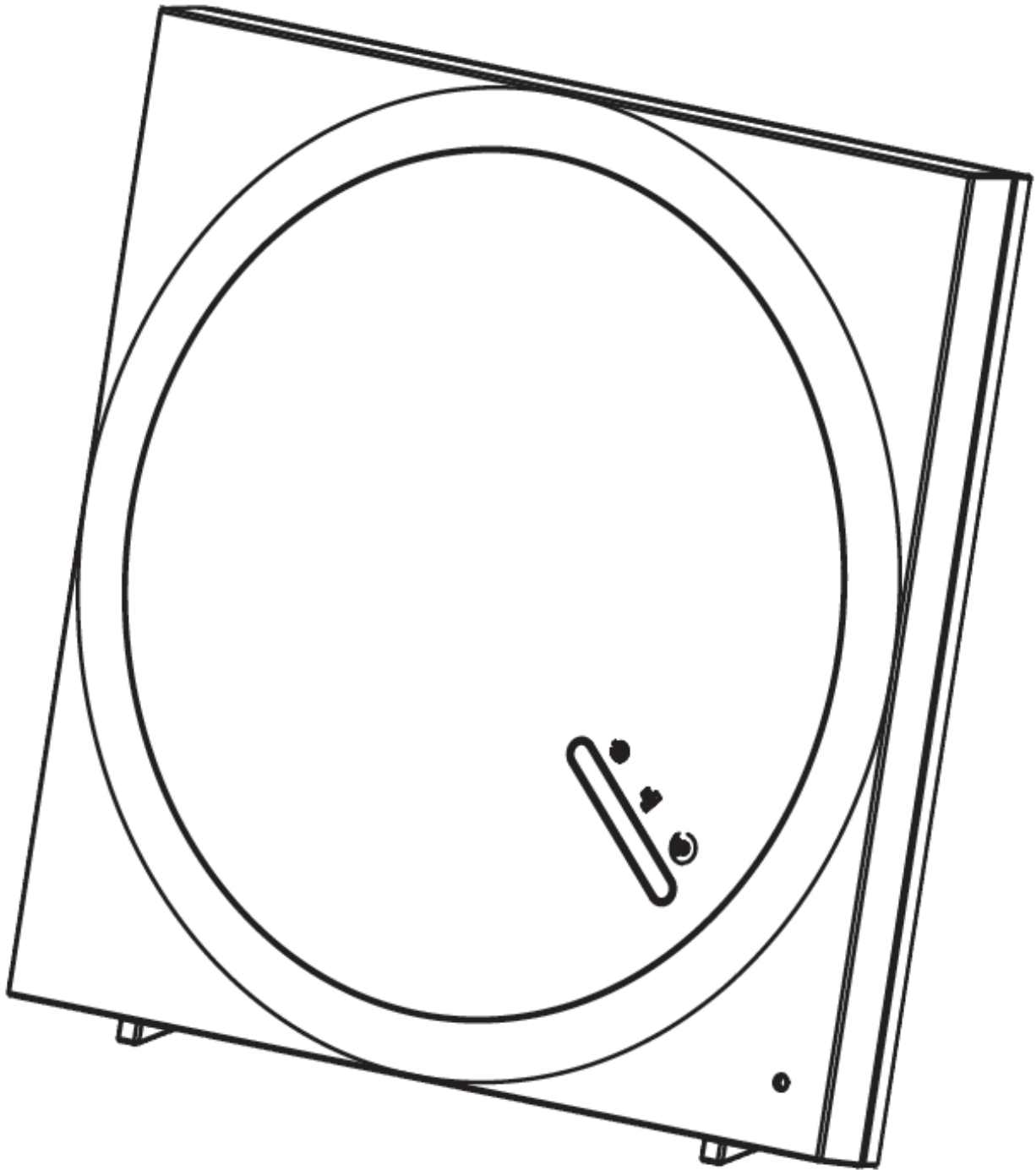

Security Tech Germany

SHGW10000

# QUICKGUIDE



Installing the Gateway

Supported Smartphone System Version:

**iOS: iPhone or iPad**

Requires iOS 6.0 or later

**Android Smartphone or Tablet**

Requires Android 4.0 or later

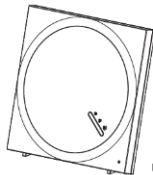

Step 1: Download the ABUS Z-Wave One APP



Step 2: Add the Gateway

Click on the „Add a gateway“ and follow the further instructions in the app.

Step 3: Login

Press the Gateway icon to log in to the Gateway.

Assign a secure administrator access now by entering an admin account name and password.

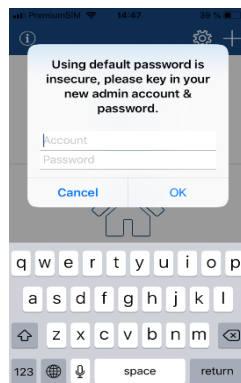
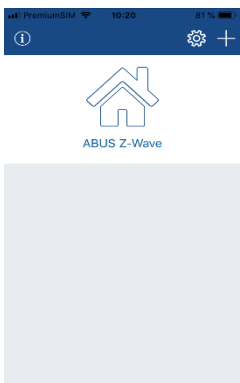

Step 4: Add a Z-Wave Component

To add a Z-Wave device into the Gateway (Inclusion), follow the steps below:

1. Set the gateway inclusion mode
  - a. Press "Component"
  - b. Press „+“
  - c. Choose between ABUS devices or other devices
  - d. Follow the inclusion steps of the respective device
  
2. When the gateway detects the Z-Wave component, a "Di" tone is output.
  
3. After you have assigned a name to the component, the gateway confirms the successful inclusion with a success tone.

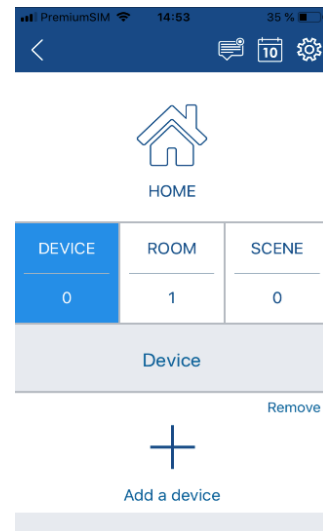

*Note: If the inclusion failed, check whether The Z-Wave frequency of the device is the same as of the Gateway (EU). It may be necessary to exclude the device before attempting to include it again. Select the "-" symbol in the component view here and perform the exclusion procedure.*

Step 5: Add a new room

1. Press the „Room“ Icon
2. Press „+“
3. Assigning a name

After a room has been created, included devices can be added to it. To do this, either go to the room overview and press “+” to add device or assign the room in the device overview.

If temperature, humidity and/or brightness sensors have been added to a room, the respective values are displayed as a preview in the room overview. If there are several devices with the same parameter, you can choose which value shall be displayed in the preview.

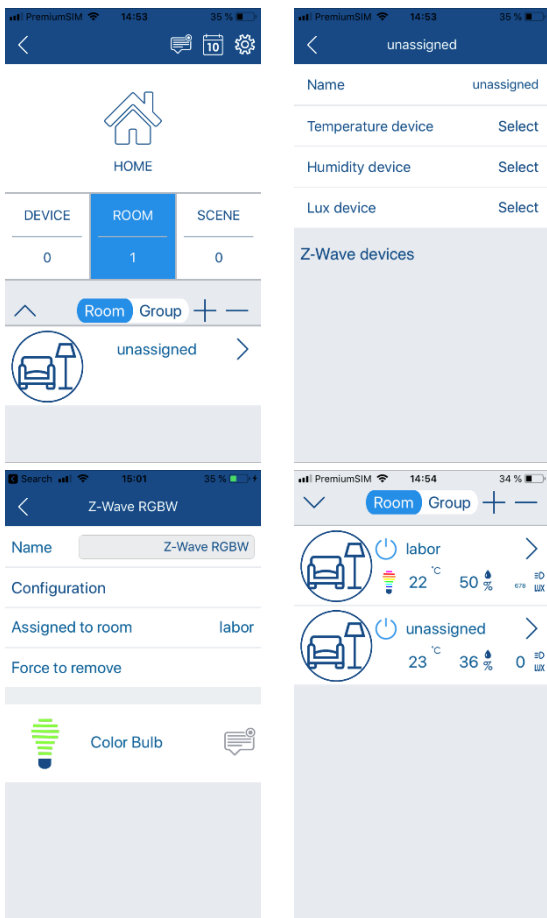

Step 6: Create a new scene

Up to 60 scenes can be created on each gateway, each scene consists of IF/THEN/WHEN elements.

“IF” is the condition under which the scene is to be triggered, up to 6 conditions per scene are possible. These can be and/or based. The “IF” conditions can be set according to the status of the Z-Wave devices, Smartvest, room conditions or gateway status.

“THEN” are the actions of the scene, up to 6 actions are possible per scene. The “THEN” actions can be applied to Z-Wave devices, Smartvest, room actions or gateway status.

“WHEN” allows the scene to check different conditions which conditions can be, e.g. always, every day, every week or during a certain period of time. When no time interval is assigned, the condition “always” will be applied automatically.

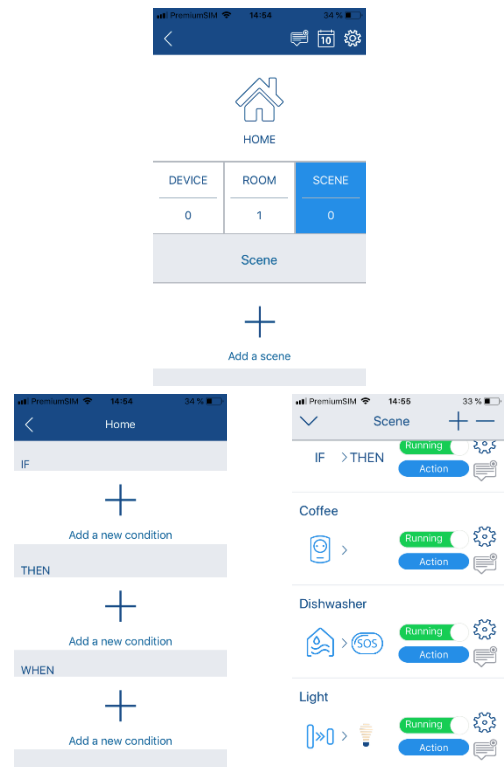

FAQ

**What should I do if I have forgotten my password?**

Press the Reset button for five seconds. The gateway will restore the factory settings. The default admin account is admin without password.

**How do I exclude a device from the component list if it is defective or lost?**

If your device can no longer establish a connection to the gateway, it can be removed from the gateway by pressing the following ICON:



*Note: If a device does not respond for more than 24 hours, the  symbol appears*

**Why my device cannot be included?**

1. Make sure that your Z-Wave gateway and the device communicate on the same frequency.
2. Your device may already be connected to another Z-Wave network, so try an exclusion first.
3. The battery of the device is empty.

**What is the default admin login?**

Standard admin user: admin

Standard admin password: \_\_\_\_\_ (empty)

Scope of delivery

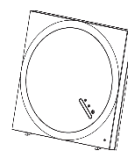

Gateway

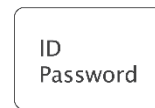

ID / Password Card



Quickguide



Ethernet Cable

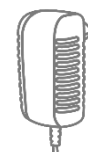

Power Supply 5V / 1,5A  
(DC-Stecker: 3,5 x 1,35mm)

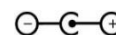

Product description

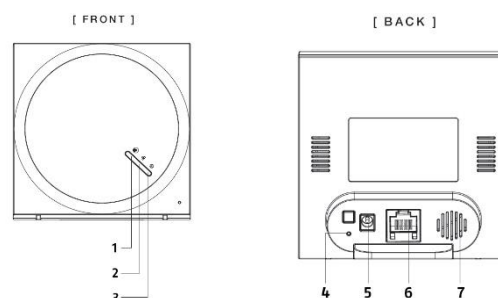

1	Z-Wave LED-Indicator
2	Netzwerk LED-Indicator
3	Status LED-Indicator
4	Reset-Button
5	Power Supply (5V DC / 1A)
6	LAN-interface
7	Speaker

Z-Wave configuration

**Association group**

Group No.	Max. Nodes	Description
1	1	Z-Wave Plus Lifeline, report Device Reset Locally when reset

**Device Detection**

Added device will detect automatically, users can control it (on/off, change color, lighting, etc.) and watch information (battery, meter, etc.) via Z-Wave ONE App.

**Different brands**

Z-Wave enabled device can be included and excluded normally. Included devices will show on device list. All non-battery powered nodes can act as repeaters regardless of manufacturers.

**Basis command**

Basic command is useful in a scene.

**Replication**

Controller can transmit protocol replication data automatically.

**About Security**

This controller is a security enabled Z-Wave Plus product. If necessary, it will use encrypted Z-Wave Plus messages to communicate to other security enabled Z-Wave Plus products.

**BASIC SET**

For unknown device, press device icon will show on/off icon, select on/off and press ok will send BASIC SET 0xff/0x00.

Z-Wave Command Classes

**Supported Z-Wave Command Classes:**

- COMMAND\_CLASS\_ZWAVEPLUS\_INFO\_V2
- COMMAND\_CLASS\_VERSION\_V2
- COMMAND\_CLASS\_ASSOCIATION\_GRP\_INFO
- COMMAND\_CLASS\_ASSOCIATION\_V2
- COMMAND\_CLASS\_MANUFACTURER\_SPECIFIC\_V2
- COMMAND\_CLASS\_SECURITY
- COMMAND\_CLASS\_SECURITY\_2
- COMMAND\_CLASS\_DEVICE\_RESET\_LOCALLY
- COMMAND\_CLASS\_APPLICATION\_STATUS
- COMMAND\_CLASS\_POWERLEVEL
- COMMAND\_CLASS\_CONTROLLER\_REPLICATION
- COMMAND\_CLASS\_BASIC
- COMMAND\_CLASS\_CRC\_16\_ENCAP
- COMMAND\_CLASS\_TRANSPORT\_SERVICE\_V2
- COMMAND\_CLASS\_SUPERVISION

**Controlled Command Classes:**

- COMMAND\_CLASS\_BASIC
- COMMAND\_CLASS\_SECURITY
- COMMAND\_CLASS\_SECURITY\_2
- COMMAND\_CLASS\_ASSOCIATION\_GRP\_INFO
- COMMAND\_CLASS\_ASSOCIATION\_V2
- COMMAND\_CLASS\_WAKE\_UP\_V2
- COMMAND\_CLASS\_MULTI\_CHANNEL\_V4
- COMMAND\_CLASS\_SWITCH\_BINARY
- COMMAND\_CLASS\_SWITCH\_MULTILEVEL\_V2
- COMMAND\_CLASS\_SENSOR\_BINARY\_V2
- COMMAND\_CLASS\_SENSOR\_MULTILEVEL
- COMMAND\_CLASS\_METER
- COMMAND\_CLASS\_COLOR\_CONTROL
- COMMAND\_CLASS\_DOOR\_LOCK
- COMMAND\_CLASS\_NOTIFICATION\_V4
- COMMAND\_CLASS\_BATTERY
- COMMAND\_CLASS\_SENSOR\_ALARM
- COMMAND\_CLASS\_INCLUSION\_CONTROLLER
- COMMAND\_CLASS\_CRC\_16\_ENCAP



Security Tech Germany

- ① DE Eine alternative Inbetriebnahme sowie detaillierte Informationen erhalten Sie in der Bedienungsanleitung erhältlich auf der Website:  
[abus.com/product/SHGW10000](https://abus.com/product/SHGW10000)
- ② FR Vous trouverez une alternative de mise en service ainsi que des informations détaillées dans le manuel d'utilisateur disponible sur le site Internet : [abus.com/product/SHGW10000](https://abus.com/product/SHGW10000)
- ③ NL Een alternatieve ingebruikname en gedetailleerde informatie vindt u in de gebruikershandleiding op de website: [abus.com/product/SHGW10000](https://abus.com/product/SHGW10000)
- ④ IT Per informazioni su una messa in funzione alternativa o sui dettagli del prodotto, consultare le istruzioni per l'uso disponibili all'indirizzo:  
[abus.com/products/SHGW10000](https://abus.com/products/SHGW10000)
- ⑤ GB An alternative installation as well as detailed information can be found in the user manual which is available on the website:  
[abus.com/product/SHGW10000](https://abus.com/product/SHGW10000)
- ⑥ DK Alternativ idrifttagning samt detaljerede oplysninger findes i betjeningsvejledningen, som findes på hjemmesiden:  
[abus.com/product/SHGW10000](https://abus.com/product/SHGW10000)
- ⑦ PL Informacje dotyczące alternatywnych sposobów uruchomienia oraz dodatkowe szczegóły znajdują się w instrukcji obsługi, którą można pobrać na stronie: [abus.com/product/SHGW10000](https://abus.com/product/SHGW10000)
- ⑧ ES En el manual de instrucciones disponible en nuestra página web podrá consultar una puesta en funcionamiento alternativa, así como información más detallada. [abus.com/product/SHGW10000](https://abus.com/product/SHGW10000)
- ⑨ SE Alternativ idrifttagning samt detaljerad information finns i bruksanvisningen som kan hämtas på webbsidan: [abus.com/product/SHGW10000](https://abus.com/product/SHGW10000)